

BABY LOCK EMBROIDERY ACCESSORIES

Embroidery Foot with Needle Beam

(BLTY-EF)

By plugging in the connector on the back of your machine, the Needle Beam or embroidering needle drop point will be indicated on the fabric, allowing you to accurately position your embroidery design.

Instructions: Attaching the Embroidery Foot with Needle Beam

1. Raise the presser foot lever.
2. Push the black button on the presser foot holder and remove the presser foot.



1. Black button
 2. Presser foot holder
- Remove the presser foot from the presser foot holder

3. Use the included screwdriver to loosen the screw of the presser foot holder, then remove the presser foot holder.

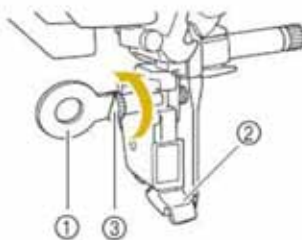

1. Screwdriver
 2. Presser foot holder
 3. Presser foot holder screw
- Remove the presser foot holder



4. Position the embroidery foot with Needle Beam on the presser foot bar by aligning the notch of the presser foot to the large screw.

Side View

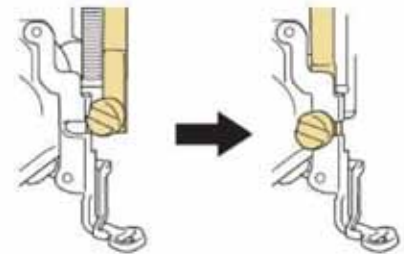

5. Hold the embroidery foot in place with your right hand, and use the included screwdriver to securely tighten the presser foot holder screw.

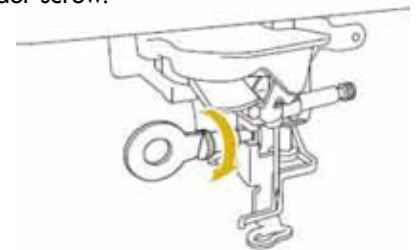

6. Plug the connector of the embroidery foot with Needle Beam into the jack on the back of your machine.

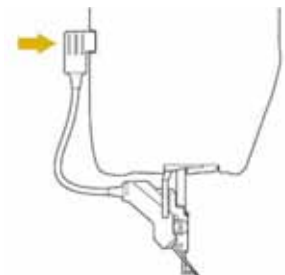

FOR THE LOVE OF SEWING