



*Getting to Know:*

Anna

A-LINE SERIES  
**Model BL20A**



**FOR THE LOVE OF SEWING**

---

Baby Lock Consumer Helpline: 800-313-4110  
[www.babylock.com](http://www.babylock.com)



# Anna

## Model BL20A

No matter what you're sewing, Anna is the supportive friend who's always ready to boost your confidence and cheer you on. With several convenient features such as a drop-in bobbin, 15 built-in stitches including a 4-step buttonhole, this machine is perfect for beginning sewers. Anna is a great friend to turn to for mending, hemming and even crafting.

This Getting to Know Guide will take you through a simple, step-by-step project that will help you familiarize yourself with your new machine. Refer to the instructions and reference guide (packaged with your machine) for additional directions.



**FOR THE LOVE OF SEWING**



## Winding the Bobbin

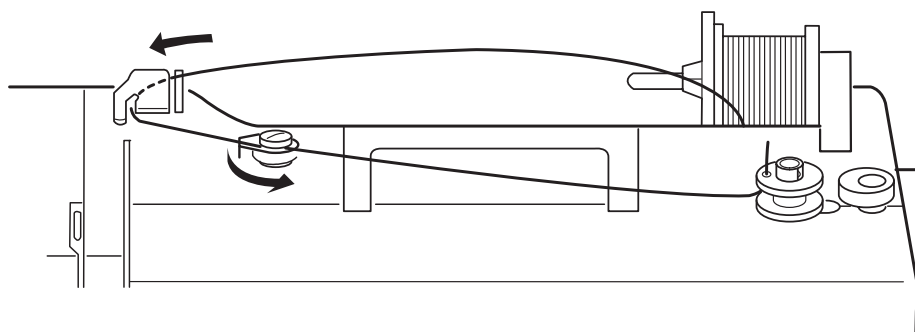

1. Hold the thread with both hands and guide the thread from back to front under the thread guide ①.
2. Guide the thread into the bobbin winding thread guide ②.

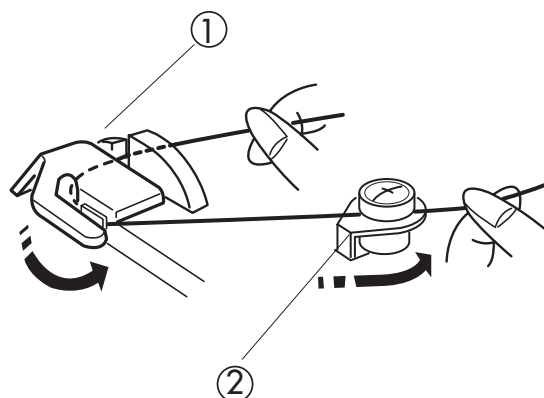

3. Pass the thread through the hole in the bobbin from the inside to the outside. Put the bobbin on the bobbin winder spindle ③ and rotate the bobbin until it clicks into place.

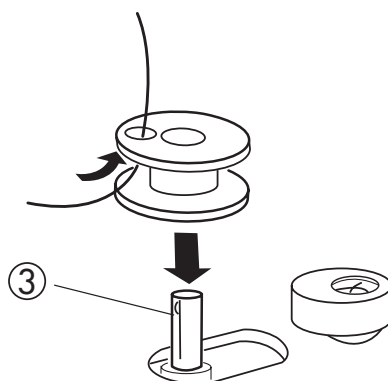



4. Push the bobbin winder spindle to the right.

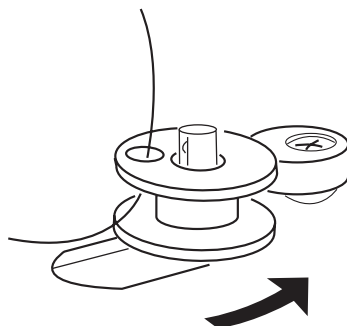

5. Hold the free end of the thread in your hand and start the machine. Stop the machine when the bobbin has been wound a few layers, and cut the thread close to the bobbin.

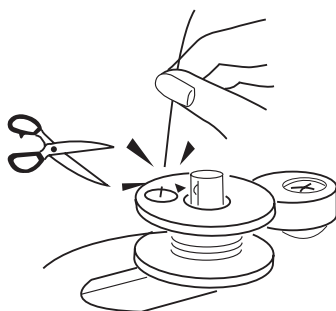

6. Start the machine again. When the bobbin is fully wound, it will stop automatically. Stop the machine and return the bobbin winder spindle to its original position by moving it to the left, and cut the thread with a pair of scissors. Remove the bobbin from the bobbin winder spindle.

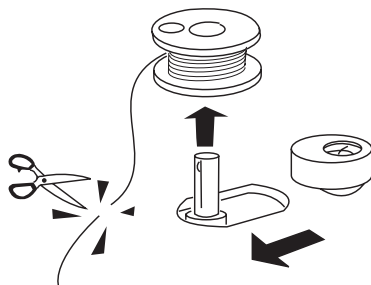

**NOTE:** The machine will not sew until the spindle has been returned to the left.



## Removing & Inserting the Bobbin

1. Push the hook cover plate release button ① to the right and remove the cover plate ②.

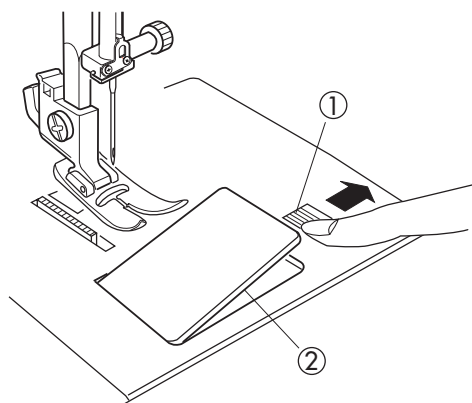

2. Lift out the bobbin ③.

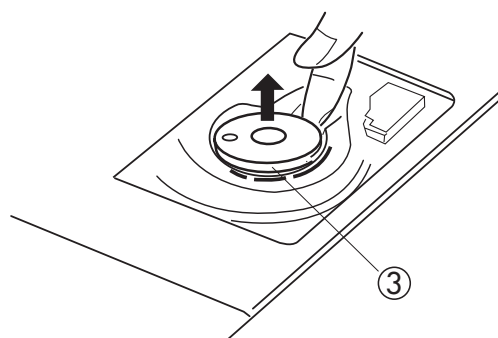

3. Place the bobbin into the bobbin holder with the thread ④ running off as illustrated.

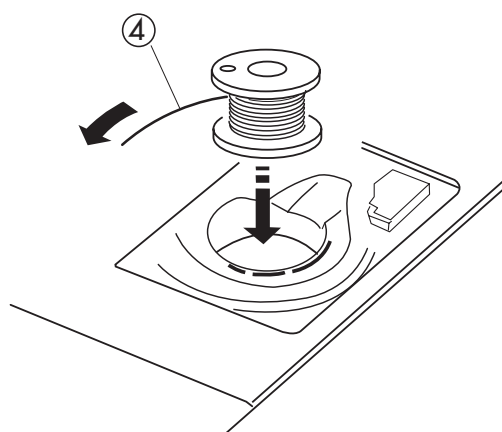



4. Guide the thread into the front notch⑤ on the front side of the bobbin holder. Draw the thread to the left, sliding it between the tension spring blades ⑥.

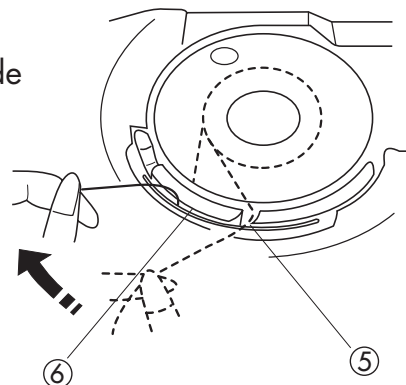

5. Continue to draw the thread lightly until the thread slips into the side notch⑦.

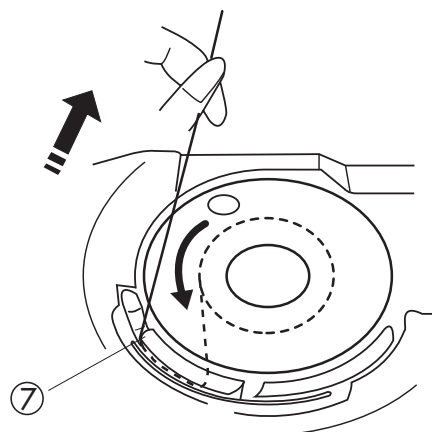

6. Pull out about 4" of thread ⑧. Attach the hook cover plate ⑨ by inserting the two prongs on the left of the hook cover plate into the openings. Lower the right side until it clicks into place. Check the threading by referring to the chart shown on the hook cover plate.

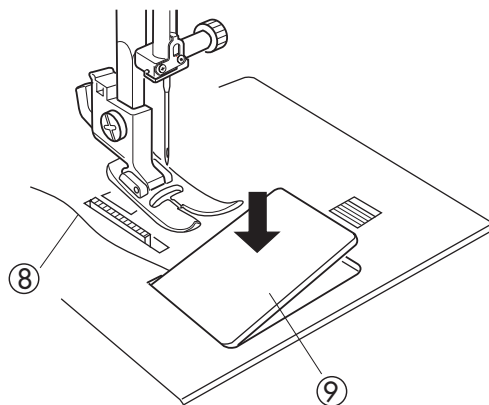



## Threading the Machine

Raise take-up lever to its highest position by turning the handwheel toward you.  
Raise presser foot.

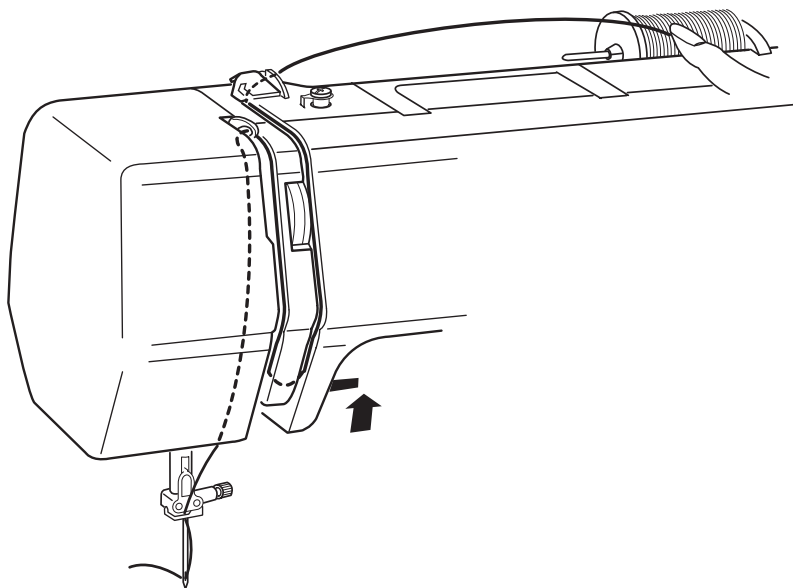

1. Draw the thread from the spool and guide it under the thread guide① from back to front. Then draw it down along the right channel.

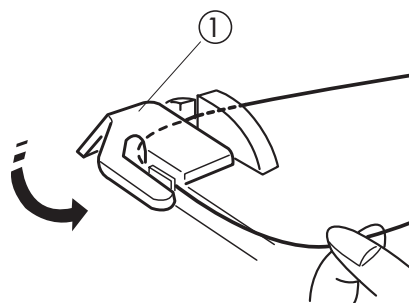

2. Draw the thread up around the bottom of the thread guide plate②. Pull the thread up along the left channel

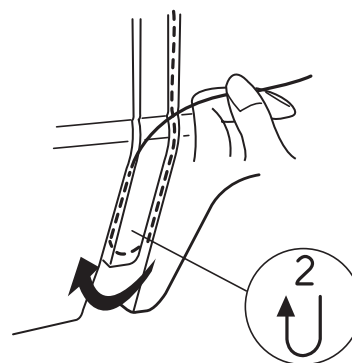



3. Firmly draw the thread from right to left over the thread take-up lever ③ and down into the take-up lever eye.

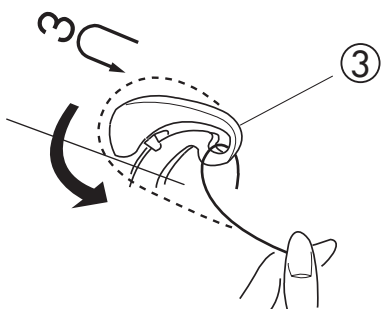

4. Draw the thread down along the left channel and slip the thread behind the needle bar thread guide ④ from the left.

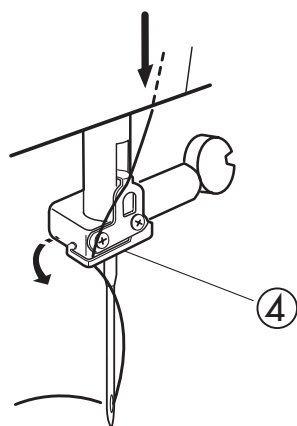

5. Pass the thread through the needle eye from the front to the back.

**Note:** You may want to cut the end of the thread with sharp scissors for easier needle threading.





## Drawing up the Bobbin Thread

1. Raise the presser foot and hold the needle thread ① lightly with your left hand.

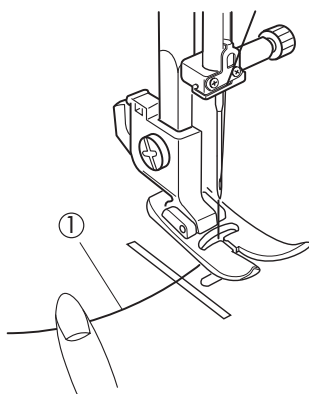

2. Turn the handwheel slowly toward you one complete turn. Bring the bobbin thread ② up by pulling the needle thread as illustrated.

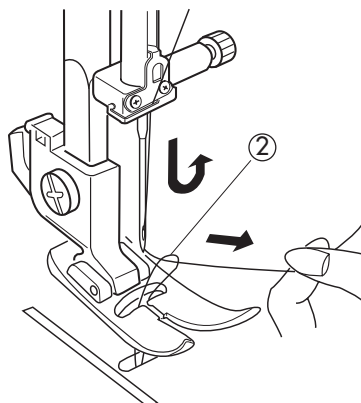

3. Pull 4" (10 cm) of both threads back and under the presser foot.

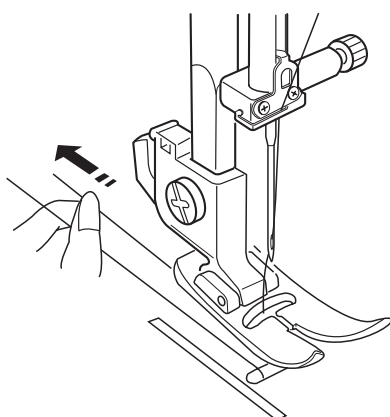



## Selecting the Stitch Pattern

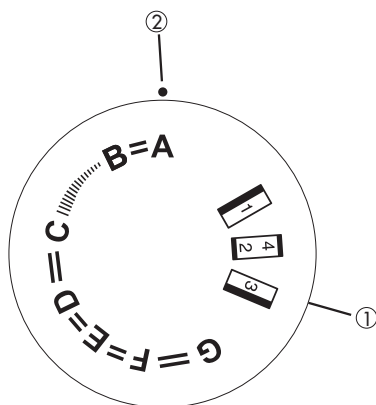
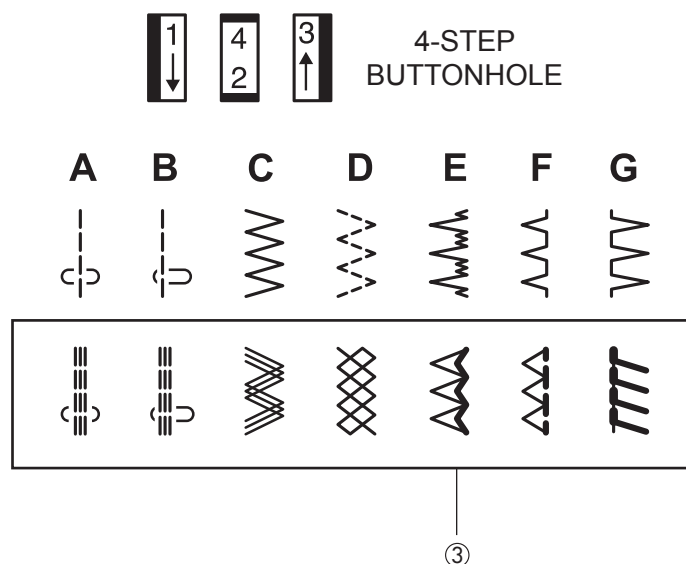

### Pattern Selector Dial

1. Raise the needle to its highest position.
2. Turn the pattern selector dial ① to set the symbol of the desired stitch pattern at the setting mark ②.

CAUTION: Do not turn the pattern selector dial while the needle is in the fabric, otherwise the needle may bend or break.

3. To select the stretch stitch patterns ③, turn the stitch length dial counterclockwise past the "4" to S.S. setting

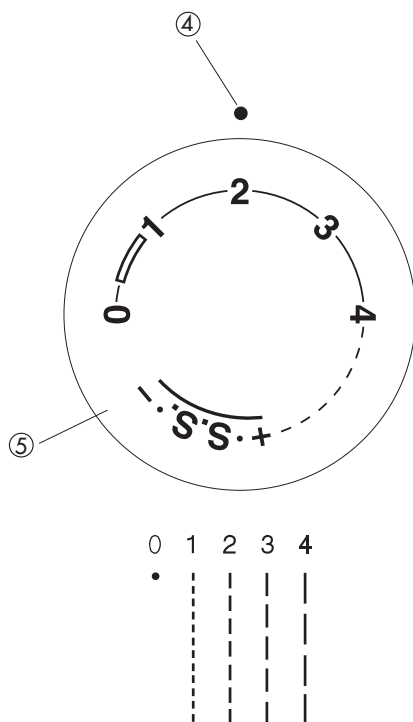

### Stitch Length Dial

1. Turn the stitch length dial (5) to set the desired stitch length number at the setting mark (4).
2. The higher the number, the longer the stitch
3. The "□" mark shows the adjustment range when sewing the buttonhole.

### Adjusting Stretch Stitch Balance

If the stretch stitch patterns are uneven when you sew on a particular fabric, correct them by turning the stitch length dial.

If the patterns are drawn out, correct them by setting the dial to the "-" side.

If the patterns are compressed, correct them by setting the dial to the "+" side.

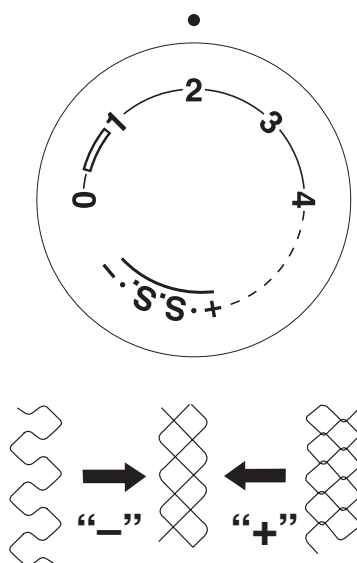



## Starting to Sew

### **Straight Stitch Sewing**

Machine settings:

Stitch pattern: A

Stitch length: 1.5 - 4

Thread tension: 2 - 6

Presser foot: Zig zag foot A

1. Raise the presser foot and place the fabric under the foot.

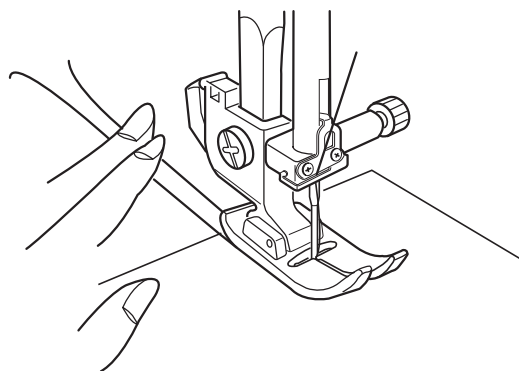

Lower the needle into the fabric. Lower the presser foot and smooth the threads toward the back. Depress the foot control.

### **To Change Sewing Direction**

1. Stop the machine and turn the handwheel toward you to bring the needle down into the fabric.
2. Raise the presser foot.
3. Pivot the fabric around the needle to change sewing direction as desired.
4. Lower the presser foot and continue sewing.

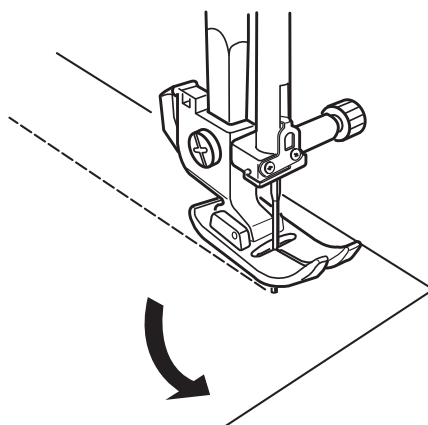



### **Finishing sewing**

1. Press the reverse stitch button and sew several stitches in reverse at the end of the seam.

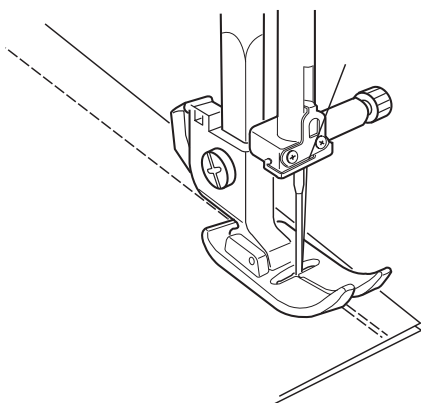

2. Raise the presser foot and remove the fabric, drawing the threads to the back.

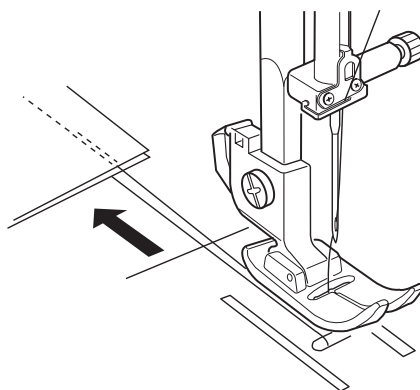

3. Draw the threads up and into the thread cutter. The threads are cut the proper length for starting the next seam.

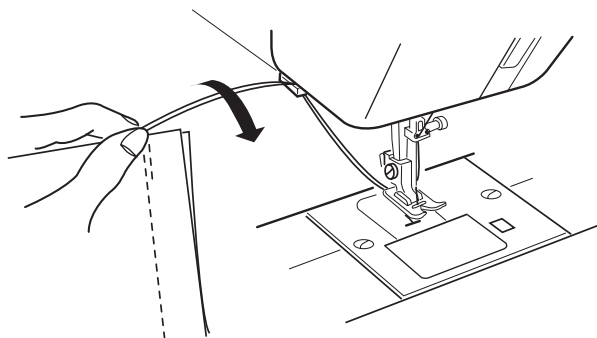



**Add a flirty, feminine touch to your favorite denim jacket, and transform a simple pillowcase into an adorable child's sundress!**

## Adorned Denim Jacket & Pillowcase Dress

### Supplies:

- Baby Lock Anna sewing machine
- Purchased denim jacket
- Purchased standard pillowcase
- 3-4 yard spool of decorative ½" wide ribbon
- 3 yards decorative trim or lace
- 1 package of extra wide double-fold bias tape
- 14" of ¼" wide elastic
- All-purpose thread
- Small sharp sewing scissors
- Pins
- Seam ripper
- Chalk
- Tape measure
- Hot-fix wand and crystals OR beads or buttons and hand sewing needle

### INSTRUCTIONS:

#### Jacket

1. Position the ribbon and trim on the front, back and sleeve of the denim jacket. Rotate and move around the pieces until you are satisfied with their placement.
2. Pin in place.
3. Thread the machine with all-purpose thread and select a straight stitch or zig zag stitch.
4. Stitch along the edge of each trim piece to secure it to the denim jacket.
5. Embellish around and on top of the trims using the hot-fix applicator wand and apply crystals or by hand sewing on beads or buttons.



*For other exciting projects like this one, visit [www.totallystitchin.net](http://www.totallystitchin.net) and [www.babylock.com](http://www.babylock.com)*



## INSTRUCTIONS:

### Pillowcase Dress

1. Cut the end seam off the pillowcase. This will be the top.

**Note:** If the desired length of the dress is shorter than the pillowcase, cut off excess from the end seam side, not the finished pillowcase hem before continuing on to the next step.

2. To form the armholes, measure down 4" to 5" on each side and mark with chalk. Then measure over 2 1/4" from the side and mark with chalk.

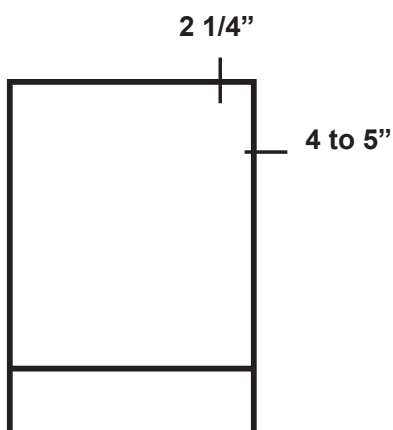

3. Draw in a slight curve from each of the marks.
4. Fold under the center section on the front and back to form a casing.

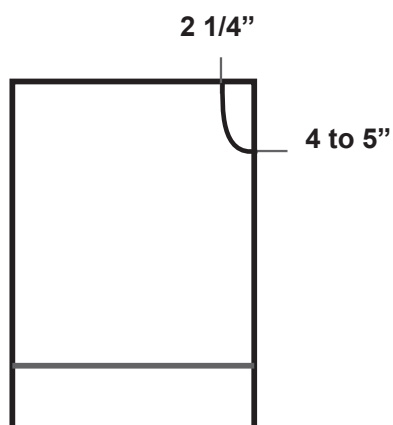

5. Cut the elastic into two equal pieces. Thread one piece of elastic through the front casing and secure it at the ends with a few tack stitches.
6. Repeat this for the casing on the back.
7. Divide the bias tape from the package in half equally and cut it into two pieces.
8. Fold each piece and mark the center with a pin.
9. Align the center of the bias tape with the lowest part of each armhole, encasing the raw edge in the folds of the bias tape. Pin in place.
10. Stitch along the armholes to secure the bias tape over the fabric edge.
11. Continue stitching the remaining bias tape closed to form the shoulder tie strings on the dress.
12. If the ties are too long trim as desired.



FOR THE LOVE OF SEWING



**FOR THE LOVE OF SEWING**

---