

BABY LOCK

SEWING ACCESSORIES

Teflon Zipper Foot

(BLDY-TZF)

Instructions

When using vinyl, this is the best sewing foot for inserting zippers, snap tape, and more. The Teflon coating keeps the foot from sticking to the surface of the fabric. Adjust the needle to sew both sides of your zipper easily. You can also use it to attach piping or decorative cording.

MACHINE SETTINGS

Stitch type:	Straight stitch
Stitch width:	Check & adjust needle position so the needle does not strike the foot
Stitch length:	1-5 mm

Centered Zipper is the most common application and is often used for bags and other applications where some zipper of the zipper is visible.

1. Select a straight stitch.
2. Attach the all-purpose presser foot and sew straight stitches up to the zipper opening. Change to a basting stitch (or longest stitch length setting) and sew to the top of the fabric.

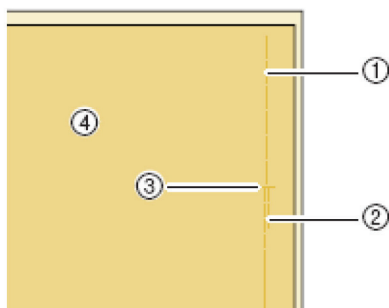

- ① Basting stitches
- ② Reverse stitches
- ③ End of zipper opening
- ④ Wrong side of fabric

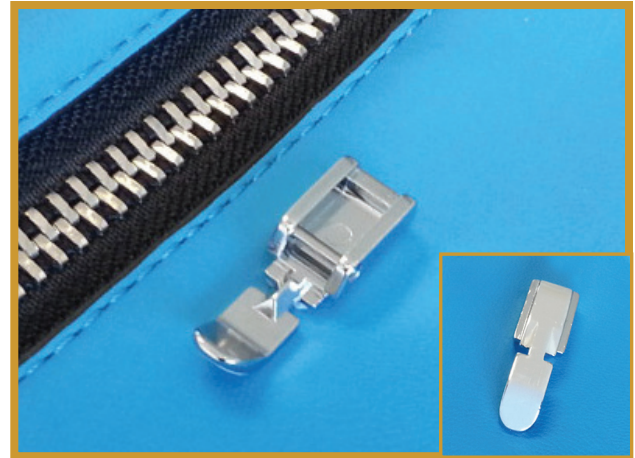

3. Press the seam allowance open and attach the zipper with a basting stitch in the middle of each side of the zipper tape.

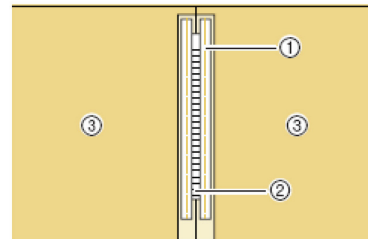

- ① Basting stitches
- ② Zipper
- ③ Wrong side of fabric

4. Remove the presser foot. Align the presser foot and attach the zipper foot. **Note:** Make sure you adjust the needle position.
5. Topstitch 7 to 10 mm (approx. 1/4 to 3/8 inch) from the seamed edge of the fabric, then remove the basting.

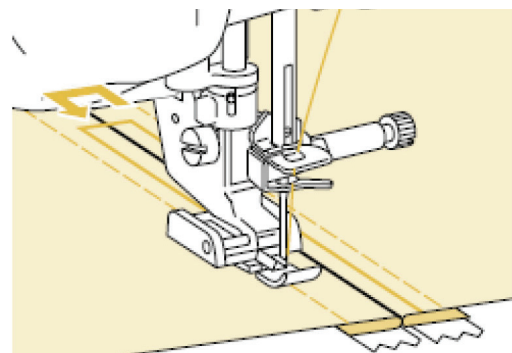

Side or Lapped Zipper is the most commonly used for skirts and dress applications where the zipper is covered by a fold of the fabric and is not visible.

6. Follow steps one and two from previous page.
7. Press the seam allowance open and align the folded hem along the teeth of the zipper, while maintaining 3 mm (approx. 1/8 inch) of sewing space.

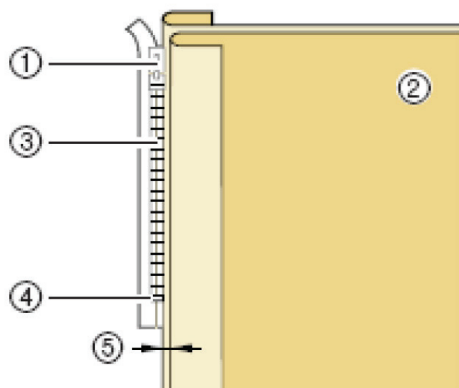

- ① Zipper pull tab
- ② Wrong side of fabric
- ③ Zipper teeth
- ④ End of zipper opening
- ⑤ 3 mm (approx. 1/8 inch)

13. Close the zipper, turn the fabric over, and sew a basting stitch.

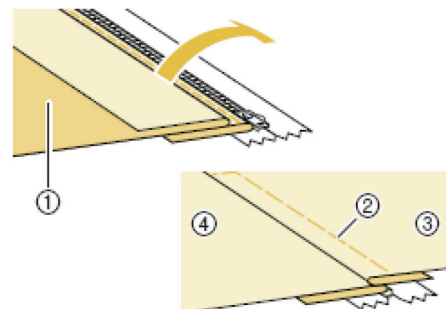

- ① Front of skirt (wrong side of fabric)
- ② Basting stitches
- ③ Front of the skirt (right side of fabric)
- ④ Back of the skirt (right side of fabric)

14. Move the needle, to the left side of the foot
15. Set the fabric so that the left edge of the presser foot touches the edge of the zipper teeth.
16. Sew reverse stitches at the top of the zipper, then continue sewing.
17. Stop sewing about 50 mm (approx. 2 inches) from the edge of the fabric.
18. Open the zipper and sew the rest of the seam.

8. Remove the all-purpose presser foot.
9. Align the needle on the right side of the zipper foot.
10. Set the presser foot in the 3 mm (approx. 1/8 inch) margin
11. Starting from the end of the zipper opening, sew to a point about 50 mm (approx. 2 inches) from the edge of the fabric, then stop the machine.
12. Pull down the zipper slider, then continue sewing to the edge of the fabric.

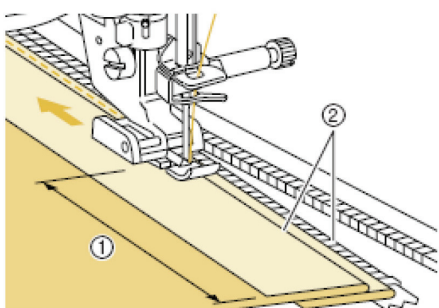

- ① 50 mm (approx. 2 inches)
- ② 3 mm (approx. 1/8 inch)

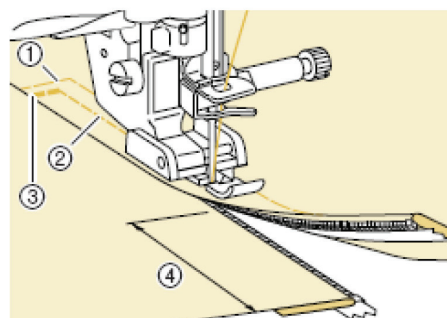

- ① Basting stitches
- ② 7 to 10 mm (approx. 1/4 inch to 3/8 inch)
- ③ Reverse stitches
- ④ 50 mm (approx. 2 inches)



FOR THE LOVE OF SEWING

www.babylock.com