

# UPGRADING YOUR MACHINE'S SOFTWARE

You can use USB media or a computer to upgrade software for your sewing machine. When an upgrade program is available on "[www.babylock.com](http://www.babylock.com)", please download the files following the instructions on the website and steps below.



## Note

- When using USB media to upgrade the software, check that no data other than the upgrade file is saved on the USB media being used before starting to upgrade.

## Upgrade Procedure Using USB Media

- 1 While pressing the "Automatic Threading" button, turn the main power to ON.

→ The following screen will appear on the LCD.

- 2 Press .

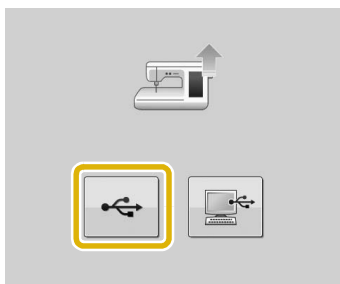

- 3 Insert the USB media into the USB port for media/mouse on the machine. The media device should only contain the upgrade file.

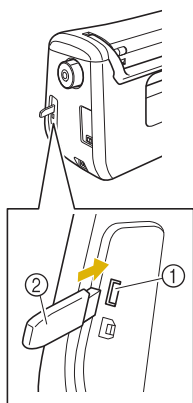

- ① USB port for mouse/media (USB 2.0)
- ② USB media



## Note

- The access lamp will begin blinking after inserting USB media, and it will take about 5 to 6 seconds to recognize the media. (Time will differ depending on the USB media).

- 4 Press .



→ The upgrade file is loaded.



## Note

- If an error occurs, a red text error message will appear. When the installation is performed successfully, following message will appear.



- 5 Remove the USB media, and turn the machine off and on again.

## Upgrade Procedure Using Computer



**Note**

- Do not connect any additional USB media devices to your computer when using the USB cable.

**1** While pressing the “Automatic Threading” button, turn the main power to ON.

→ The following screen will appear on the LCD.

**2** Press  .

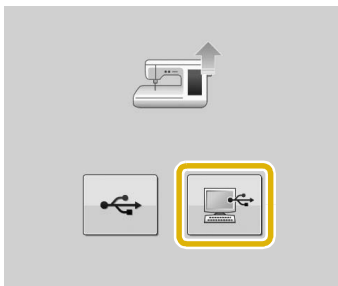

**3** Plug the USB cable connector into the corresponding USB ports for the computer and for the machine.

→ “Removable Disk” will appear in “Computer (My computer)”.

**4** Copy the upgrade file to “Removable Disk”.

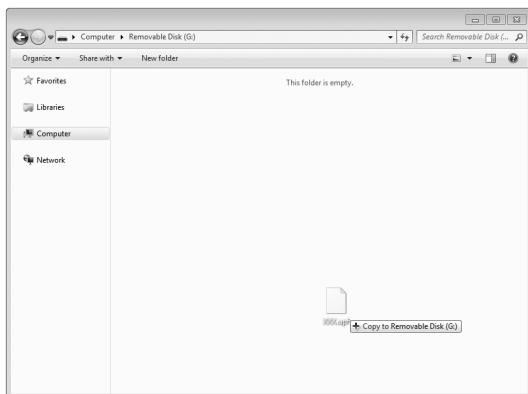

→ The following message will appear.



**5** When the message disappears, press

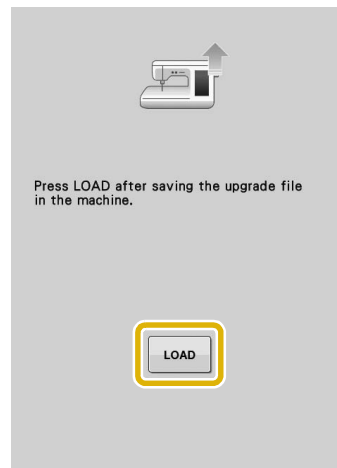

→ The upgrade file is loaded.



**Note**

- If an error occurs, a red text error message will appear. When the installation is performed successfully, following message will appear.

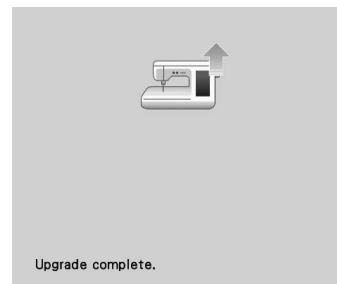

**6** Unplug the USB cable, and turn the machine off and on again.