



Baby Lock Aurora (Model BLMAR) Software update version 1.50

August 2022

Introduction

If the software version of your Aurora (Model BLMAR) is earlier than version 1.50, an update program is now available for download to improve its performance.

Version 1.50 update will provide the following change:

1. **Reset to Default** menu is added to the settings screen.
All saved data, customized settings and network information in the machine can be erased.
2. Improved the thread color palette screen when using a pattern data that contains the embroidery thread brands that are not defined in the embroidery machine.
3. Improved the processing of opening DST file that you transfer from "Design Database Transfer".
4. Improve wireless network connectivity.
5. Revised the wording of the message.

How to confirm the software version of your BLMAR



1. Turn on the machine. The LCD comes on. If the opening movie is played, press anywhere on the screen.

2. Touch  (Settings key) on the operation panel.



The settings screen appears.



3. Switch screens by using  (Previous page key)  (Next page key) to display the software version.



4. If the version shown in the screen is already "**1.50**" or later, it is not necessary to update your machine with this software version,



How to update your machine's software

You must use a formatted USB flash drive to update your machine's software.

***** NOTE *****

- Do not turn off your machine while the machine is saving the update software to itself. If the machine's power is turned off while saving the update software, it may result in damage to the machine.
- Use a 4GB to 8 GB USB flash drive when updating the machine.
- Check that no data is saved on the **formatted** USB flash drive, before beginning update.

1. Insert the USB flash drive into the USB port on the computer.
2. Copy only the update file, MWCTE1A150.upf to the USB Flash drive.
3. Safely remove the USB flash drive from the USB port on the computer.

4. Turn on your machine while pressing and holding  (Needle position button).

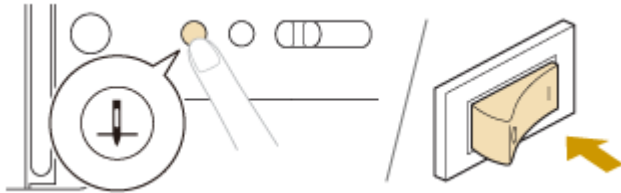

5. The following screen will appear on the LCD.

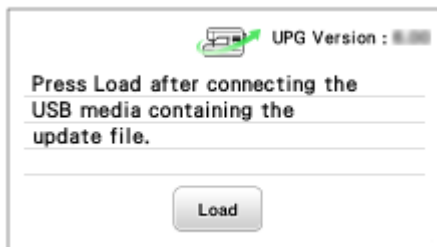

6. Insert the USB flash drive into the USB port on the machine.

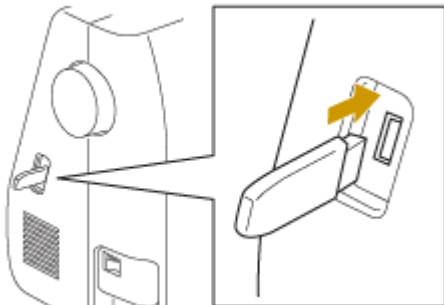

7. Touch  (Load key).

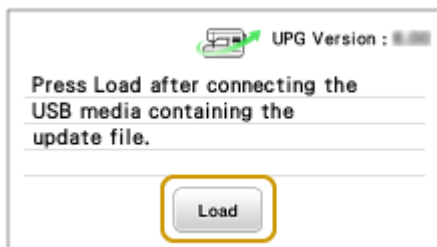



8. The following screen appears on the LCD. Do not turn off your machine while the machine is saving the update software to itself.



9. When the following screen appears, updating is completed.



10. Remove the USB flash drive and turn the machine off and on again.
11. The machine's software has been updated to version 1.50.