

Updating the Baby Lock Regent

- Select the *Information* key in the top right corner of the screen to display the board and firmware revision numbers for the Regent machine, display, and sensors.
- If the numbers displayed are lower than the the firmware update versions shown in the illustration on the right, you should download and install the update(s) to improve the machine's performance.

IMPORTANT: Always update the machine code first, then the display code, and finally the sensor code.

Begin by powering down the machine and disconnecting the Stitch Harmony table insert interface from the front bobbin area of the machine, then power on the machine again.

The Stitch Harmony communication can disrupt the programming sequence and can corrupt the program file when installing the machine and display codes.

1. Copy the update file(s) to a formatted USB drive.
2. Touch the Tools icon in the toolbar. Then touch the Update icon.
3. Place the USB stick into the port on the right side of the display as shown.
4. Wait for the color of the selection buttons to change from gray to gold.
5. Select the machine icon for update.
6. While the machine update is processing, the display screen stays on and a countdown number appears above the machine update button icon. The update for the machine is done when the countdown reaches zero.
7. Turn off the machine, remove the USB drive, leave the Stitch Harmony cable disconnected, wait a few minutes, then turn on the machine. Repeat steps 2-4, then select the display icon for update.
8. While the display update is processing, the screen will go blank and you will hear three beeps until the update has completed and the screen comes back on.
9. Turn off the machine, **keep the USB inserted**, reconnect the Stitch Harmony cable, wait a few minutes, then turn on the machine.
10. Repeats steps 2 and 4, then select the sensor icon for update.
11. While the sensor update is processing, the display screen stays on and a countdown number appears above the sensor update button icon. The update for the sensor is done when the countdown reaches zero.
12. Turn off the machine, remove the USB drive, leave the Stitch Harmony cable connected, wait a few minutes, then turn on the machine.
13. Select the Information key in the top right corner of the screen to confirm that the machine, display, and sensor updates installed successfully.

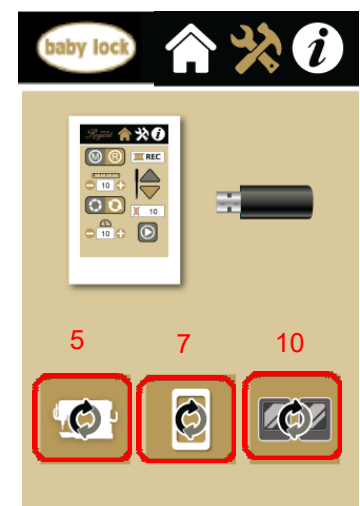
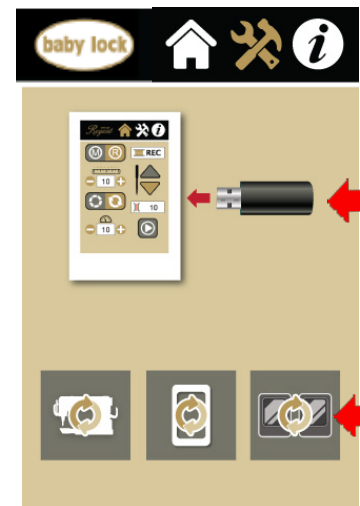
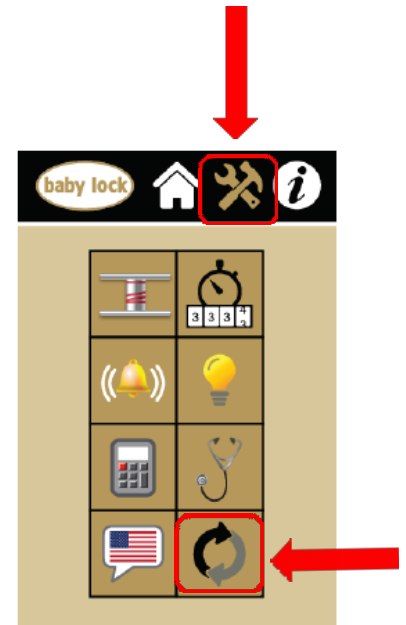
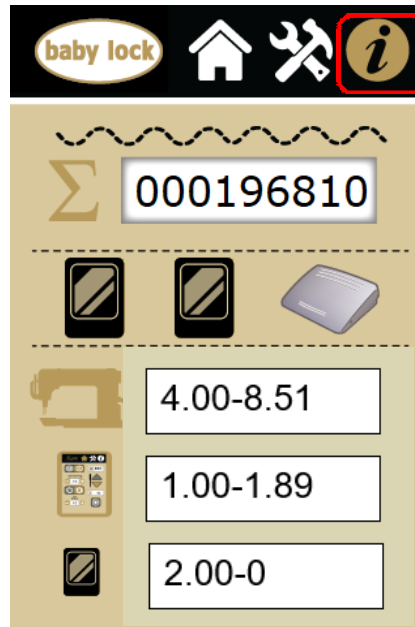

Baby Lock Regent (Model BLRT18) Update History

Regent Machine code (version 8.51):

- Release Notes: Fixes issue of the needle sense failure during walk incorrectly popping up the reprogram sensor controller error message.
- File Name: Machine.hql
- File Size: 63.6 KB

Regent Machine code (version 8.50):

- Reduces the timeout with the communication between the motion sensor and the machine.
- File Name: Machine.hql
- File Size: 63.1 KB

Regent Machine code (version 8.47):

- Improved the response to a needle up/down press of the foot controller. Also fixes issue with some foot controllers starting the machine on their own.

Regent Display code (current version 1.89):

- This update fixes an issue that can happen if the needle down or needle up button is pressed multiple times instead of holding the button for a walking stitch operation.
- File Name: DisplayF.S19
- File Size: 1.32 MB

Regent Display code (version 1.87):

- Prevents using the needle up/down buttons until the machine is fully stopped.
- File Name: DisplayF.S19
- File Size: 1.30 MB

Regent Display code (version 1.84):

- Fixed an issue with cruise speed setting.

Regent Sensor code (version 2.0):

NOTE: Please insert the USB stick in the display (on the right side) before turning on the machine, then proceed with the update.

- Added automatic Com Port detection for Regent.
- Improved Communication speed between machine and stitch regulation sensors.
- Improved image quality detection of stitch regulation sensors.
- Added stitch regulation filter to improve regulation.
- Added support for new QF01501 analog foot pedal.
- Fixed status reporting to machine to indicate foot pedal type.
- File Name: Sensor.s19
- File Size: 92.2 KB

Regent Sensor code (version 1.10):

- Improves stitch regulation.
- File Name: Sensor.S19
- File Size: 40.5 KB